



POLYESTER	DELTA	50			
		KS	6	8	16
#1 50 16 2150 #2 50 16 1200 15 50 6 500 18 50 6 379 27 50 16 10450 28 50 8 1350	2150 1200 500 379 10450 1350	2 6 500 379 189.5 171.5	4.3 72.0 20.9		
CELESTION DELTA	(m)	(s)	189.5	407.8	97.2
AMMONIUM	(kg)	(m)	42.1	160.9	153.4
CELESTION AMMONIUM (kg)					356.4

12.10.24 16:29					
Dzn.	Sit	ks	Delika	Sirka	kg
A00	KY-81	40	5000	2150	85.9
					3435.7

	KY-81		5000	2150	3435.7	3435.7
--	-------	--	------	------	--------	--------

Hmotnost celken:	3435.7
------------------	--------

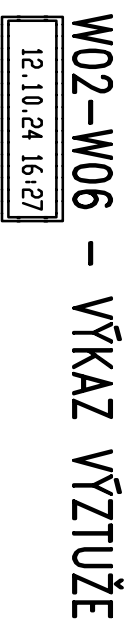
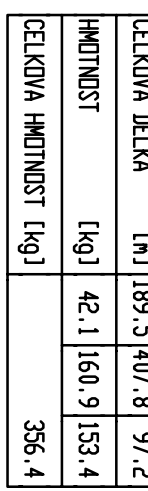

Pol	Profil	Beta	50		
	[cm]	ks	6	8	16
12	50	16	12000		120.0
16	50	6	500	297.5	
20	50	8	1750	171.5	
27	50	16	10450		20.9
38	50	2			
Paket	CELESTIA MELIA (M)				
prisku	(297.5   171.5   140.9)				
	HOMINIST	log)	66.0	67.7	222.4
6	CELESTIA HMI. (log)				
	HMI. PRO 6 PRISKU				
	2136.5				

Dzn.	Sit ks	Delka	Sirka	kg	cel.kg
A00	KY-81	62	5000	2150	85.9
					5325.3

Hmotnost celkem:	5325.3
Pocet polozek: 6	

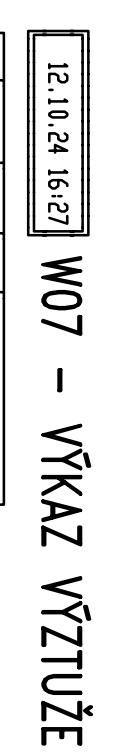

Pol. Profil	Beleko [m]	ks	50	
			6	8
15.50	16	2		15.5
16.50	16	2		16
17.50	16	2		17
18.50	6	500	863	96.0
19.50	6	1750	966	
20.50	16	10450	171.5	
21.50	16	659	62.7	
22.50	6	130	349.7	
CEKUNA BELKA	[m]	283.0	321.2	174.2
HMINOST	[kg]	62.8	65.6	274.9
CEKUNA HMINOST [kg]				545.4

Dzn.	Sit	Ks	De laka	Sirka	kg	Cell	kg
A00	KY-81	58	5000	2150	85,9	4981,8	
A01	KY-81	2	5000	1050	41,9	83,9	
	KY-81		5000	2150	5065,7	5065,7	
Iznostost cel kleni:							5065,7

Hmotnost celken:	5065.7
------------------	--------



POL	PROFI	DELTA	HS	50	
				10	16
M2	50	16	12000	18	216.0
M1	50	16	12000	4	504.0
A1	50	10	12500	2	17.5
M3	50	16	12500	4	7.0
A3	50	10	3550	17.5	614.1
CELIDIA DELTA				1135.7	223.0
HMMINIST				700.2	356.0
CELIDIA HMMINIST				166.1	

HMOTNOST	[kg]	700.2	352.0
CELKOVÁ HMOTNOST [kg]			1052.1



Pol. Profil	Dikeite	ks	50			
[mm]			6	8	10	16
M1 50	16	2150	2			4.3
M2 50	16	2150	2			15.3
M3 50	16	2150	2			15.3
M4 50	10	12000	32			1104.0
M5 50	10	12000	32			504.0
M6 50	6	500	46315	2257.5		
M7 50	6	500	46315	2257.5		
M8 50	10	12000	32			17.5
M9 50	10	12000	32			1372.0
M10 50	16	3500	2			7.0
M11 50	16	3500	2			614.1
M12 50	10	3550	173			209.0
M13 50	10	3550	20			
M14 50	8	1500	434	365.9		
CELKOVÁ HEDKA			2257.5	1957.9	1135.7	1339.8
HEDKOST	[kg]		501.1	772.6	700.2	2114.7
CELKOVÁ HEDKOST [kg]						4088.4

Pol Profil	$\Delta e$ [ka]	ks	50			
			6	8	10	16

*1	50	16	2150	2	4.3
*2	50	16	7750		15.3
*12	50	16	12000	92	1104.0
*14	50	10	12000		504.0
*15	6	500	4515	2257.5	
16	50	10	1250	14	17.5
17	50	10	1750	784	
18	50	16	3500		1372.0
23	50	16	7500		7.0

12.10.24 16:30											
Den.	S.t	ks	Dejka	S.rnka	kg	Del kg					
A00	Ky-81	470	5000	2150	65,9	40389,5					
A01	Ky-81	2	5000	1050	41,9	83,9					
	Ky-81	5000	2150	40453,4	40453,4						
Hmotnost celkem:						40453,4					
S.t	Nazev	F1 [cm]	Rozi [cm]	Dejka	S.rnka	M					
		pod	pr	pod	pr	[cm]	[cm]	[kg]			
A	Ky-81	8	0	8	0	100	100	5000	2150	65,9	
											----

Hmotnost celkem:	40453,4
------------------	---------

Sit	Nazev	f i [mm]	Rozf [mm]	De lka	S i rka	M	V y r o b c e
		pod pr i	pod pr i	[mm]	[mm]	[kg]	
A	KY-81	8 0 8 0	100 100	5000	2150	85.9	----

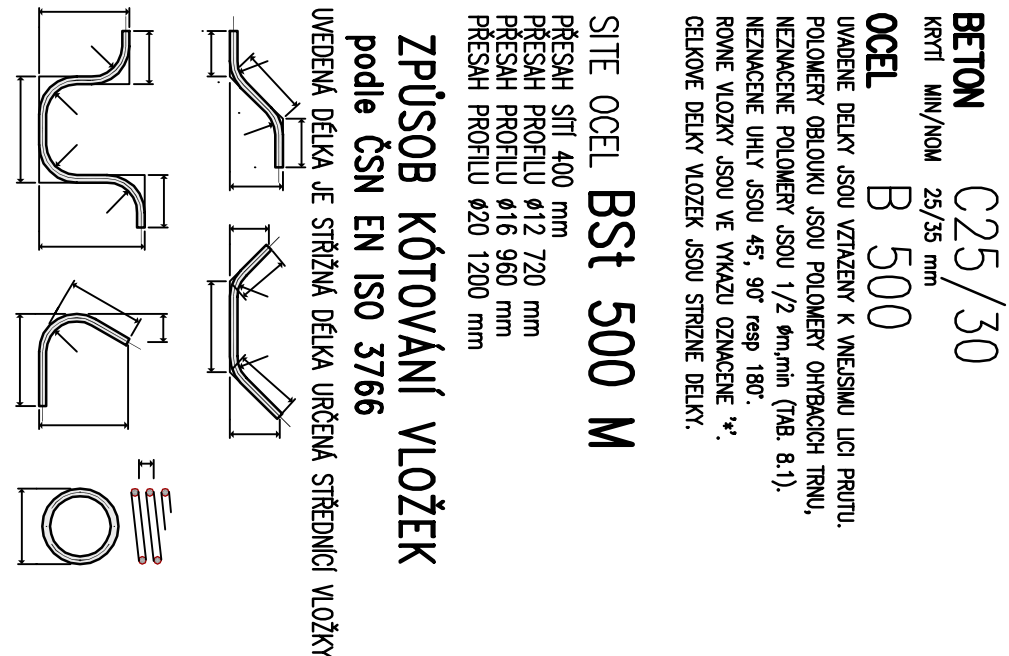
[illegible]

UVEDENÁ DÉLKA JE STŘIŽNÁ DÉLKA URČENÁ STŘEDNÍCI VLOŽKY